

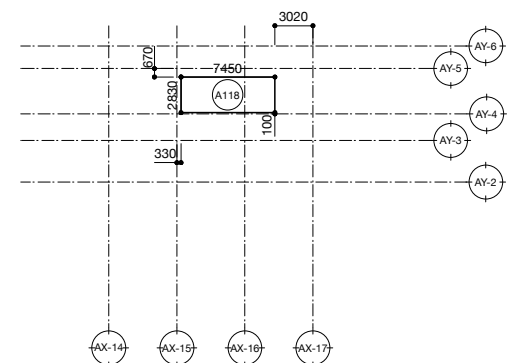

2階居室求積図

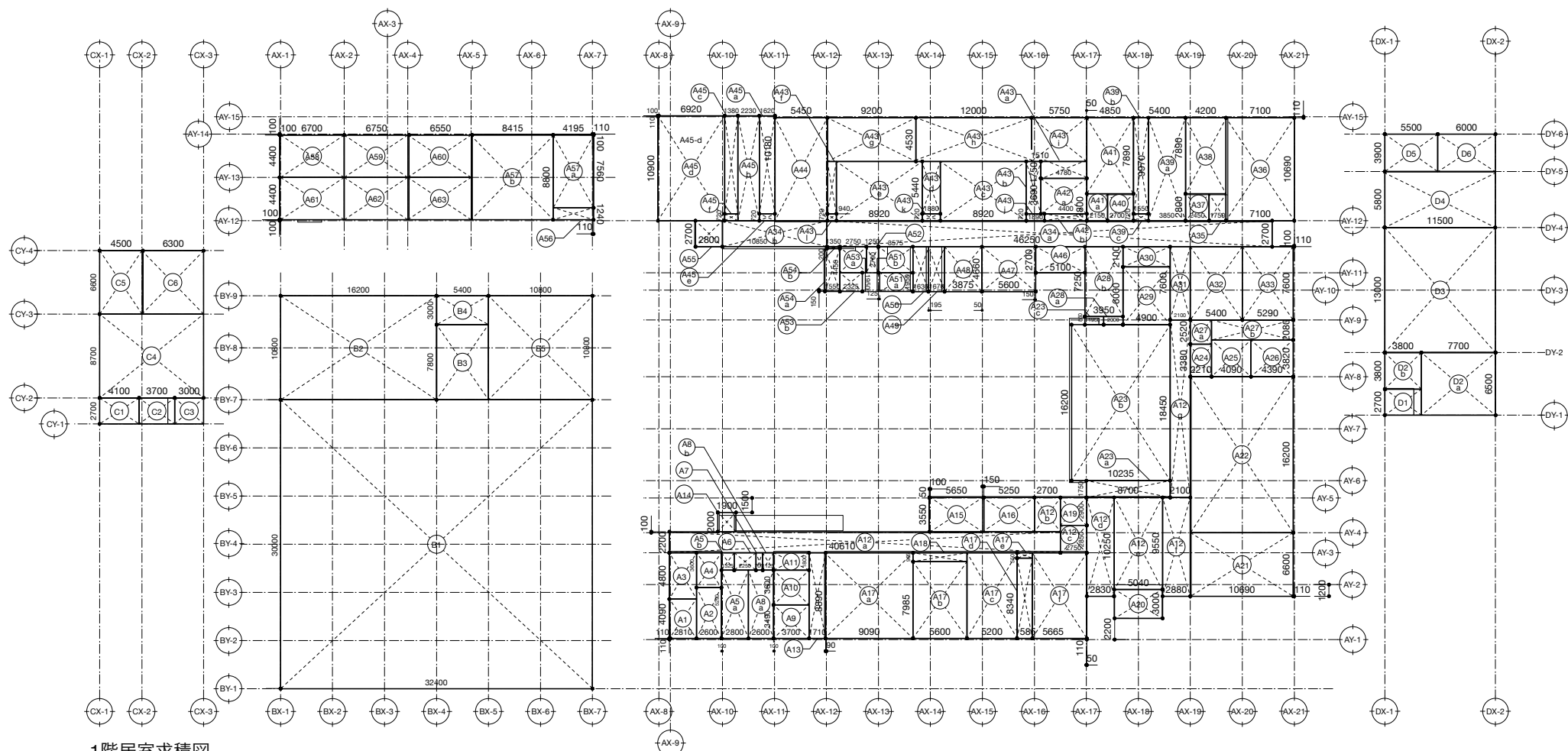

屋上階居室求積図



__1階居室求積図

工事名称	ふくしまロボットテストフィールド研究棟(仮称)整備(建築)工事	 FUJIKEN	関場・藤 特定建設工事共同企業体	完成図	図面名称 居室求積図・面積表1	図面番号 共-20
------	---------------------------------	---	------------------	-----	--------------------	--------------

A棟							
1階	室名	番号	幅(m)	×	高さ(m)	=	小計(㎡)
	女子更衣室	A1	2.810	×	4.090	=	11.493
	男子更衣室	A2	2.600	×	5.290	=	13.754
	廊下1	A3	2.810	×	4.800	=	13.488
	倉庫1	A4	2.600	×	3.600	=	9.360
	女子便所1	A5-a	2.800	×	7.090	=	19.852
		A5-b	1.325	×	1.800	=	2.385
	給湯室1	A6	2.250	×	1.800	=	4.050
	PS(給湯室1)	A7	0.700	×	1.800	=	1.260
	男子便所1	A8-a	2.600	×	7.090	=	18.434
		A8-b	1.125	×	1.800	=	2.025
	所長室	A9	3.700	×	3.490	=	12.913
	応接室	A10	3.700	×	3.600	=	13.320
	倉庫2	A11	3.700	×	1.800	=	6.660
		A12-a	40.610	×	2.200	=	89.342
		A12-b	2.700	×	3.550	=	9.585
		A12-c	2.750	×	2.850	=	7.838
		A12-d	2.830	×	10.250	=	29.008
		A12-e	5.040	×	9.550	=	48.132
		A12-f	2.880	×	10.250	=	29.520
		A12-g	2.100	×	18.450	=	38.745
	廊下3	A13	1.710	×	8.890	=	15.202
	階段4	A14	1.900	×	2.000	=	3.800
	ラウンジ1	A15	5.650	×	3.550	=	20.058
	階段1	A16	5.250	×	3.550	=	18.638
	業務室・指導員室・事務室	A17-a	9.090	×	8.890	=	80.810
		A17-b	5.600	×	7.985	=	44.716
		A17-c	5.200	×	8.890	=	46.228
		A17-d	1.585	×	8.340	=	13.219
		A17-e	1.585	×	0.550	=	0.872
		A17-f	5.665	×	8.890	=	50.362
	EPS-2	A18	5.600	×	0.905	=	5.068
	EV	A19	2.750	×	2.900	=	7.975
	風除室1	A20	5.040	×	3.000	=	15.120
	ホワイエ・打合せコーナー	A21	10.690	×	6.600	=	70.554
	セミナー室	A22	10.690	×	16.200	=	173.178
	エントランスラウンジ	A23-a	8.700	×	1.750	=	15.225
		A23-b	10.235	×	16.200	=	165.807
		A23-c	1.950	×	0.850	=	1.658
	多目的便所	A24	2.210	×	3.380	=	7.470
	男子便所2	A25	4.090	×	3.820	=	15.624
	女子便所2	A26	4.390	×	3.820	=	16.770
	廊下4	A27-a	2.210	×	2.520	=	5.569
		A27-b	8.480	×	2.080	=	17.638
	倉庫3	A28-a	2.000	×	0.850	=	1.700
		A28-b	3.950	×	7.250	=	28.638
	空調機械室	A29	4.900	×	6.000	=	29.400
	EPS-1	A30	4.900	×	2.100	=	10.290
	廊下5	A31	2.100	×	7.600	=	15.960
	通い企業開発実験室1	A32	5.400	×	7.600	=	41.040
	通い企業開発実験室2	A33	5.290	×	7.600	=	40.204
	廊下6	A34-a	46.250	×	2.700	=	124.875
		A34-b	10.850	×	2.700	=	29.295
	前室3	A35	1.750	×	2.800	=	4.900
	分析室	A36	7.100	×	10.690	=	75.899
	前室2	A37	2.450	×	2.800	=	6.860
	防塵試験室	A38	4.200	×	7.890	=	33.138
	精密測定室	A39-a	3.850	×	10.690	=	41.157
		A39-b	1.550	×	9.970	=	15.454
	PS(精密測定室)	A39-c	1.550	×	0.720	=	1.116
	前室1	A40	2.700	×	2.800	=	7.560
	倉庫4	A41-a	2.150	×	2.800	=	6.020
		A41-b	4.850	×	7.890	=	38.267
	電子制御室	A42-a	4.780	×	3.690	=	17.638
		A42-b	4.400	×	0.720	=	3.168
	加工室	A43-a	4.780	×	1.750	=	8.365
		A43-b	1.510	×	5.440	=	8.214
		A43-c	8.920	×	6.160	=	54.947
		A43-d	1.880	×	5.440	=	10.227
		A43-e	8.920	×	6.160	=	54.947
		A43-f	0.940	×	5.440	=	5.114
		A43-g	9.200	×	4.530	=	41.676
	加工室(マニピュレータ・レーザー焼結3Dプリンタ)	A43-h	12.000	×	4.530	=	54.360
	加工室(シールドルーム)	A43-i	5.750	×	4.530	=	26.048
	PS(加工室)	A43-j	1.890	×	0.720	=	1.361
		A43-k	1.880	×	0.720	=	1.354
		A43-l	0.940	×	0.720	=	0.677

環境測定室	A44	5.450	×	10.690	=	58.261	58.261
電波暗室(前室)	A45-a	1.620	×	10.180	=	16.492	130.275
	A45-b	2.230	×	10.900	=	24.307	
	A45-c	1.380	×	10.180	=	14.048	
	A45-d	6.920	×	10.900	=	75.428	
PS(電波暗室)	A45-e	1.620	×	0.720	=	1.166	2.160
	A45-f	1.380	×	0.720	=	0.994	
風除室2	A46	5.100	×	2.700	=	13.770	13.770
階段2	A47	5.600	×	4.660	=	26.096	26.096
荷物用EV	A48	3.875	×	4.660	=	18.058	18.058
男子便所3	A49	1.670	×	4.660	=	7.782	7.782
女子便所3	A50	1.630	×	4.660	=	7.596	7.596
男子シャワー更衣室	A51-a	3.450	×	1.950	=	6.728	16.380
	A51-b	3.575	×	2.700	=	9.653	
廊下7	A52	1.250	×	2.700	=	3.375	3.375
女子シャワー更衣室	A53-a	2.750	×	2.700	=	7.425	11.959
	A53-b	2.325	×	1.950	=	4.534	
貯湯槽置場	A54-a	1.550	×	4.450	=	6.898	7.168
	A54-b	1.350	×	0.200	=	0.270	
風除室3	A55	2.800	×	2.700	=	7.560	7.560
EPS-3	A56	4.195	×	1.240	=	5.202	5.202
ロボット保管室	A57-a	4.195	×	7.560	=	31.714	105.766
	A57-b	8.415	×	8.800	=	74.052	
個別倉庫1	A58	6.700	×	4.400	=	29.480	29.480
個別倉庫2	A59	6.750	×	4.400	=	29.700	29.700
個別倉庫3	A60	6.550	×	4.400	=	28.820	28.820
個別倉庫4	A61	6.700	×	4.400	=	29.480	29.480
個別倉庫5	A62	6.750	×	4.400	=	29.700	29.700
個別倉庫6	A63	6.550	×	4.400	=	28.820	28.820
小計(1階)・・・①							2629.995
							2629.99
少数点第3位以下切り捨て							
A棟							
2階	室名	番号	幅(m)	×	高さ(m)	=	計(㎡)
	倉庫5	A64	5.360	×	8.890	=	47.650
	女子便所4	A65-a	2.850	×	7.080	=	20.207
		A65-b	1.375	×	1.800	=	2.475
	男子便所4	A66-a	2.550	×	7.080	=	18.080
		A66-b	1.075	×	1.800	=	1.935
	給湯室2	A67-a	2.250	×	1.800	=	4.050
	PS(給湯室2)	A67-b	0.700	×	1.800	=	1.260
	廊下7	A68-a	43.410	×	2.200	=	95.502
		A68-b	2.700	×	3.550	=	9.585
		A68-c	2.700	×	0.750	=	2.025
	階段4	A69	11.380	×	2.000	=	22.760
	研修室1	A70	5.550	×	8.890	=	49.340
	研修室2	A71-a	3.870	×	8.890	=	34.404
		A71-b	1.530	×	8.025	=	12.277
	屋内消火栓(研修室2)	A71-c	1.530	×	0.866	=	1.324
	研修室3	A72-a	3.600	×	8.890	=	32.004
		A72-b	1.800	×	8.090	=	14.562
	PS(研修室3)	A72-c	1.800	×	0.800	=	1.440
	倉庫6	A73-a	3.800	×	7.985	=	30.343
		A73-b	1.450	×	8.890	=	12.891
	EPS2-2	A74	3.800	×	0.905	=	3.439
	研修室4	A75-a	3.750	×	8.890	=	33.338
		A75-b	1.800	×	8.025	=	14.445
	PS(研修室4)	A75-c	1.800	×	0.865	=	1.557
	研修室5	A76	5.500	×	8.890	=	48.895
	ラウンジ2	A77	2.800	×	3.550	=	9.940
	ラウンジ3	A78	2.850	×	3.550	=	10.118
	階段1	A79	5.250	×	3.550	=	18.638
	EV	A80	2.800	×	2.900	=	8.120
	ライブラリー	A81	10.600	×	4.640	=	49.184
	ライブラリーラウンジ	A82	10.800	×	5.710	=	61.668
	会議室1-2	A83	5.500	×	9.030	=	49.665
	会議室1-1	A84	5.300	×	9.030	=	47.859
		A85-a	10.690	×	1.960	=	20.952
		A85-b	2.700	×	1.510	=	4.077
	廊下9	A86	2.700	×	26.190	=	76.113
		A87-a	7.990	×	3.215	=	25.688
	会議室2-2	A87-b	7.405	×	0.835	=	6.183
	PS(会議室2-2)	A87-c	0.585	×	0.835	=	0.488
	会議室2-1	A88-a	7.405	×	0.835	=	6.183
		A88-b	7.990	×	3.215	=	25.688
	PS(会議室2-1)	A88-c	0.585	×	0.835	=	0.488
	研究室3-1	A89-a	7.990	×	3.215	=	25.688
		A89-b	7.405	×	0.835	=	6.183
	PS(研究室3-1)	A89-c	0.585	×	0.835	=	0.488

研究室3-2	A90-a	7.405	×	0.835	=	6.183	31.871
	A90-b	7.990	×	3.215	=	25.688	
PS(研究室3-2)	A90-c	0.585	×	0.835	=	0.488	0.488
女子便所5	A91-a	7.130	×	1.770	=	12.620	22.048
	A91-b	7.990	×	1.180	=	9.428	
PS(女子便所5)	A91-c	0.860	×	1.770	=	1.522	1.522
男子便所5	A92	7.990	×	2.950	=	23.571	23.571
研究室2	A93	7.990	×	4.710	=	37.633	37.633
休憩室	A94	7.990	×	2.890	=	23.091	23.091
廊下10	A95-a	59.950	×	2.700	=	161.865	241.175
	A95-b	36.050	×	2.200	=	79.310	
研究室1-10	96-a	4.450	×	10.800	=	48.060	
	96-b	1.050	×	10.070	=	10.574	58.634
PS(研究室1-10)	96-c	1.050	×	0.730	=	0.767	
研究室1-9	97-a	4.460	×	10.800	=	48.168	57.634
	97-b	0.940	×	10.070	=	9.466	
PS(研究室1-9)	97-c	0.940	×	0.730	=	0.686	0.686
研究室1-8	98-a	4.350	×	10.800	=	46.980	57.554
	98-b	1.050	×	10.070	=	10.574	
PS(研究室1-8)	98-c	1.050	×	0.730	=	0.767	0.767
研究室1-7	99-a	4.310	×	10.800	=	46.548	56.014
	99-b	0.940	×	10.070	=	9.466	
PS(研究室1-7)	99-c	0.940	×	0.730	=	0.686	0.686
研究室1-6	100-a	4.500	×	10.800	=	48.600	59.174
	100-b	1.050	×	10.070	=	10.574	
PS(研究室1-6)	100-c	1.050	×	0.730	=	0.767	0.767
研究室1-5	101-a	4.460	×	10.800	=	48.168	57.634</